

Specification of Neodymium Pot Magnets With Cylindrical Hole

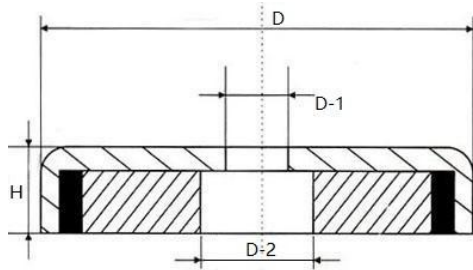

Model	D	D1	D2	H	Pull Force(kg)	Dead Weight(g)
NdFeB-B16	16	3.5	6.5	5	4	6
NdFeB-B20	20	4.5	8	7	6	12
NdFeB-B25	25	5.5	9	8	14	23
NdFeB-B32	32	5.5	9	8	23	38
NdFeB-B36	36	6.5	11	9	29	46
NdFeB-B42	42	6.5	11	9	32	75
NdFeB-B48	48	8.5	15	11.5	63	123
NdFeB-B60	60	8.5	15	15	95	266
NdFeB-B75	75	10.5	18	18	155	510

Note: common standard neodymium countersunk cup magnets are with grade of N35 and Nickel coating unless customers have other requirement. Ferrite(ceramic) magnets can used on the cup magnets in stead of neodymium magnets.